



THE *Lily Anna*

The Lily Anna's simple charm and understated elegance offers a traditional, inviting presence. The set back entrance is enhanced by a gabled roofline and rounded Venetian windows, while a variety of brick exteriors and trim details afford each home its own unique appearance.

STANDARD



B



A

**4 BEDROOM**  
**2 1/2 BATH**  
Approx. Sq. Ft. 2,362



THE

# Lily Anna

The heart of the home is the spacious family room with central fireplace – all paths lead here, from the staircase to the upper level to the efficient U-shaped kitchen with optional snack bar and adjacent nook, to the elegant front-facing library.

The private first floor master suite stands apart from the rest of the house, with independent linen closet, dedicated walk-in closet and master bath.

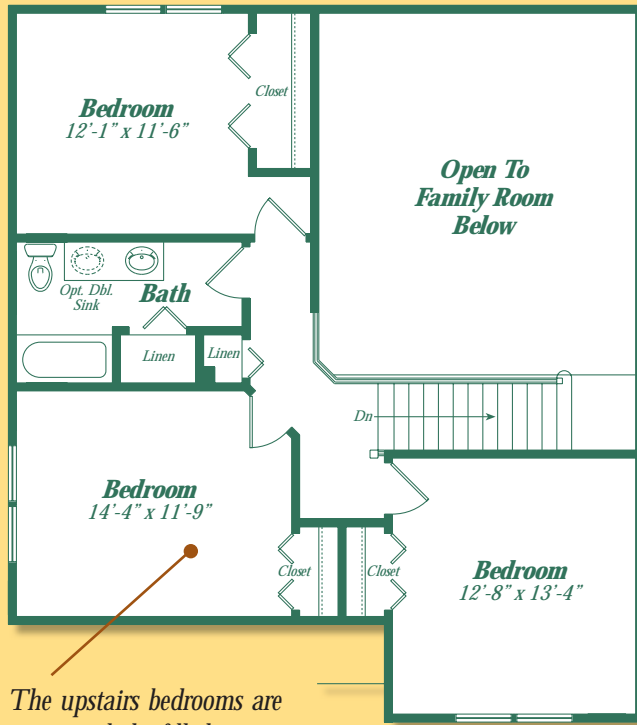

The upstairs bedrooms are spacious, light-filled spaces with large closets and access to a generous bath with optional double sink vanity.



**gtrcompanies.com**  
In our continuing effort to meet homebuyers' expectations, we reserve the right to modify features, price, specifications and/or to change or discontinue models without notice or obligation. Floor plan dimensions are approximate. Renderings are artist's conception. © 2006

