

THE LANSBURY

Homeowners will appreciate both the flexibility and functionality designed into this 2-bedroom, 2.5-bath condominium. An inviting porch opens into a foyer with guest closet and powder room, leading directly to the living room and dining room, which features sliding doors. A centrally located kitchen offers a pantry to expand storage space, and a sunny window. Upstairs, the luxurious master suite includes a private sitting area, a generous walk-in closet and full bath, offering a choice of tub or over-size shower. A walk-in closet and private bath in the second bedroom makes it perfect for overnight guests. An optional 3rd bedroom is also available. Additional thoughtful amenities include a second floor laundry area and direct access to the foyer from the 2-car attached garage.

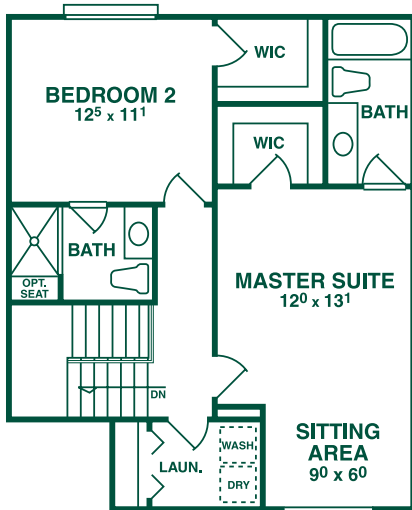
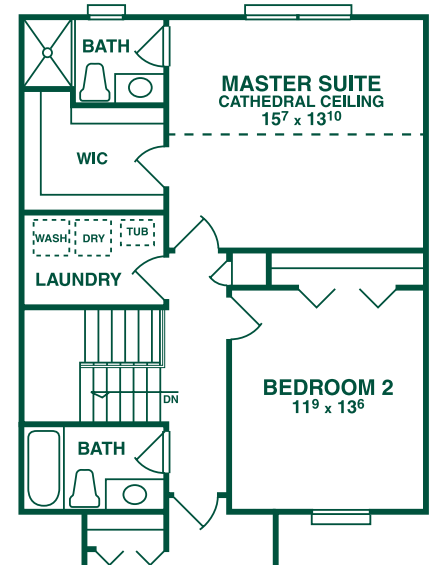
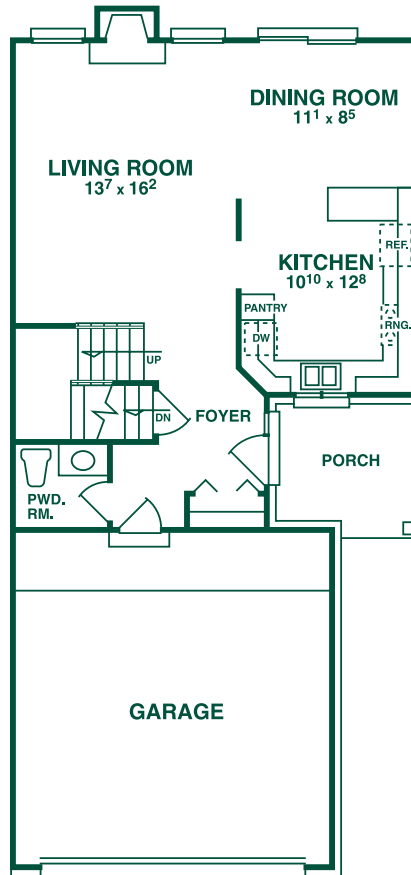

Conveniently Located on Heydenreich, Just North of Hall Road

586.465.3960

www.gtrwindemere.com



All information contained herein was accurate at the time of publication. In order to maintain the high degree of quality and incorporate management with greater facility and economy, we reserve the right to make changes in price, specifications, materials, site plan, amenity location or to change or discontinue models without notice or obligation. Renderings and illustrations are the artist's concepts.